

803-XXX

Rev.  
E

APPLICATION DRAWING

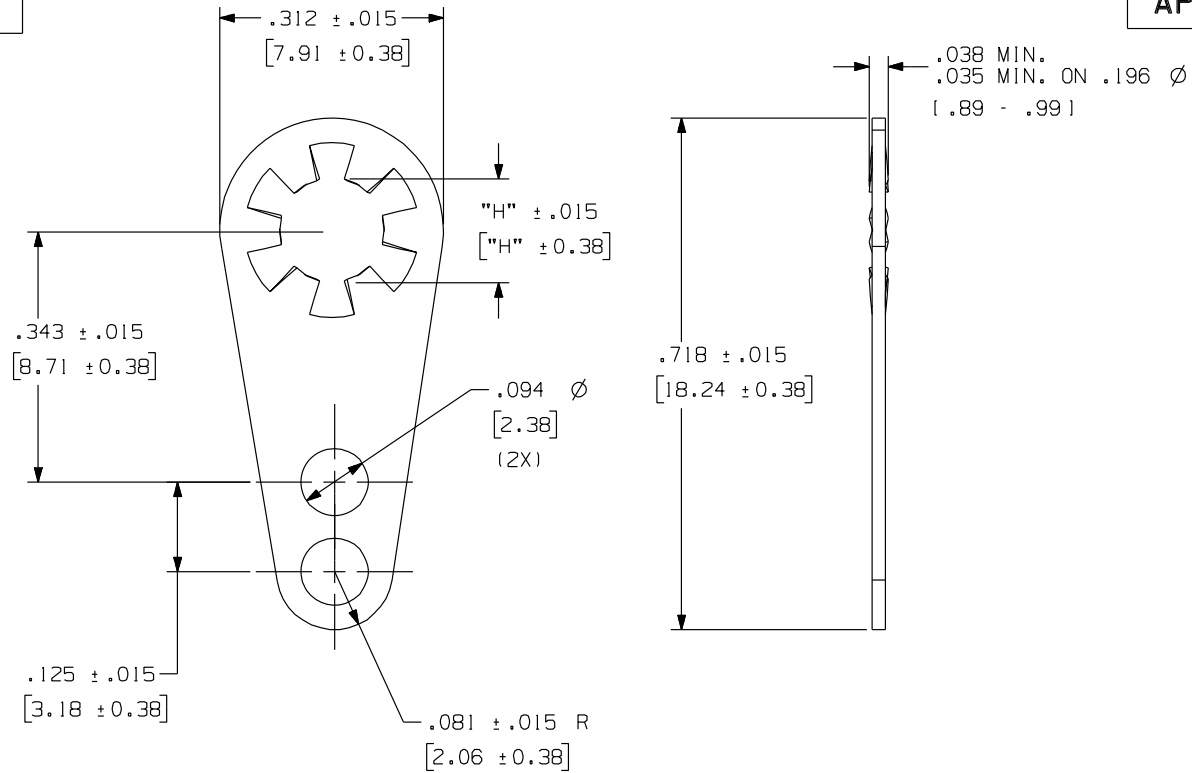

PART #	"H"	FINISH
803-120	.120 (3.05mm)	100% MATTE-TIN OVER COPPER
803-120-1	.120 (3.05mm)	60% TIN/40% LEAD HOT SOLDER DIP
803-169	.169 (4.29mm)	100% MATTE-TIN OVER COPPER
803-169-9	.169 (4.29mm)	PLAIN
803-196	.196 (4.98mm)	100% MATTE-TIN OVER COPPER
803-196-1	.196 (4.98mm)	60% TIN/40% LEAD HOT SOLDER DIP

MATERIAL
.018 (.457) BRONZE

Zierick Product Related Recommendations are general guidelines only. Since each customer's design, process and application is different it is necessary that customers thoroughly test our products in specific applications.

**ZIERICK**

Radio Circle Drive  
Mount Kisco, New York 10549

LOCKWASHER TERMINAL

THIS DOCUMENT AND THE CONFIDENTIAL INFORMATION CONTAINED HERE ARE THE PROPERTY OF ZIERICK MANUFACTURING CORPORATION AND MAY NOT BE USED IN WHOLE OR IN PART IN ANY WAY, OR COMMUNICATED TO ANY PARTY OTHER THAN THE RECIPIENT WITHOUT THE EXPRESS PRIOR WRITTEN CONSENT OF ZIERICK MANUFACTURING CORPORATION.

803-XXX

E