

NOTE:

EXCESSIVE PART MOVEMENT CAN OCCUR IF INSUFFICIENT FORCE IS USED TO PLACE PART IN PASTE, OR IF EXCESSIVE STATIC PRESSURE IS USED IN REFLOW.

RECOMMENDED SOLDER PAD GEOMETRY

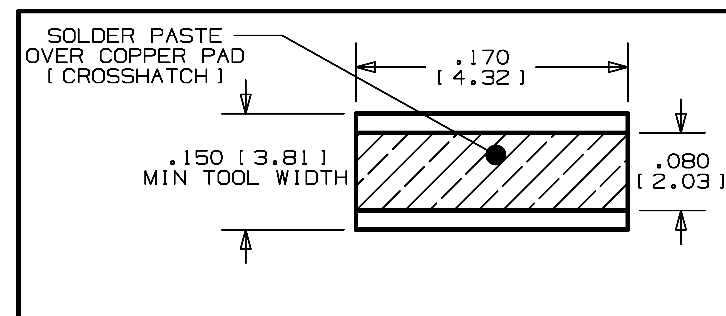

MATERIAL = .010 CDA  
PRE-PLATED BRASS

RoHS COMPLIANT

UPDATED: 03/28/18

Zierick Product Related Recommendations are general guidelines only. Since each customer's design, process and application is different it is necessary that customers thoroughly test our products in specific applications.



Radio Circle Drive  
Mount Kisco, New York 10549

THIS DOCUMENT AND THE CONFIDENTIAL INFORMATION CONTAINED HERE ARE THE PROPERTY OF ZIERICK MANUFACTURING CORPORATION AND MAY NOT BE USED IN WHOLE OR IN PART IN ANY WAY, OR COMMUNICATED TO ANY PARTY OTHER THAN THE RECIPIENT WITHOUT THE EXPRESS PRIOR WRITTEN CONSENT OF ZIERICK MANUFACTURING CORPORATION.

SMT CRIMP TERMINAL