

NOTES:

- 1/ MATERIAL: TBD
- 2/ PART TO BE CLEAN WITH NO RAGS, LOOSE BURRS, CONTAMINANTS OR CORROSION.

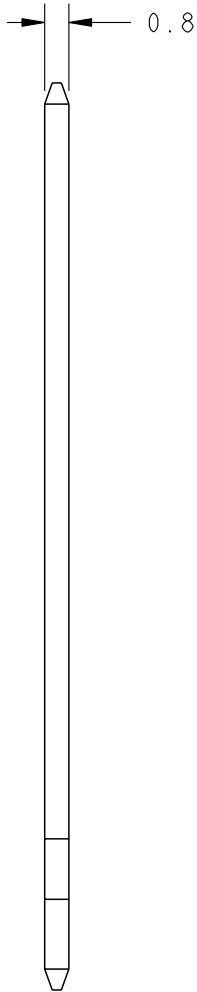
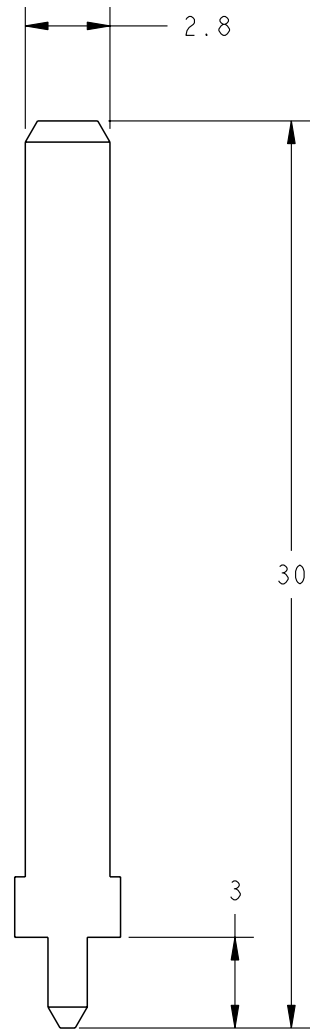

REV	SUN	BY	DD-MMM-YYYY
-----	-----	----	-------------

DO NOT SCALE		DIMENSIONING AND TOLERANCING IN ACCORDANCE WITH ASME Y14.5-1994						DIMENSIONS IN MILLIMETERS	
TOLERANCE CLASSES IN ACCORDANCE WITH ISO 2768-1		ANGLES: ±3°		STANDARD FINISH: 3.2µm		BREAK SHARP EDGES 0.5		3rd ANGLE PROJECTION	
SELECTED TOLERANCE CLASS: M		PERMISSIBLE DEVIATIONS FOR BASIC SIZE RANGE						DRAWN BY: M. URE	
DESIGNATION	DESCRIPTION	0.5* UP TO 3	OVER 3 UP TO 6	OVER 6 UP TO 30	OVER 30 UP TO 120	OVER 120 UP TO 400	OVER 400 UP TO 1000	DATE: 14-MAR-2011	
F	FINE	±0.05	±0.05	±0.1	±0.15	±0.2	±0.3	NOTICE: THIS DRAWING, SUBJECT MATTER, AND ALL INFORMATION HEREIN IS THE SOLE, EXCLUSIVE, AND CONFIDENTIAL PROPERTY OF TELEFLEX CANADA AND SHALL NOT BE DISCLOSED, COPIED, REPRODUCED, OR USED IN WHOLE OR IN PART FOR ANY PURPOSE OTHER THAN AS SPECIFICALLY AUTHORIZED IN WRITING BY TELEFLEX CANADA.	
M	MEDIUM	±0.1	±0.1	±0.2	±0.3	±0.5	±0.8		
C	COARSE	±0.2	±0.3	±0.5	±0.8	±1.2	±2		
V	VERY COARSE	-	±0.5	±1	±1.5	±2.5	±4		
* FOR NOMINAL SIZES BELOW 0.5 mm, THE DEVIATIONS SHALL BE INDICATED ADJACENT TO RELEVANT NOMINAL SIZE(S).									

TITLE: BLADE 2.8MM EPS HELM		
P.I.D. No.	DRAWING No.	REV
28BLADE	EPS_HELM_BLADE-28	28
SCALE 4:1	SIZE B	SHEET 1 OF 1